

REV. 10-26-98: MODIFIED GENERAL  
NOTE ①. ELIMINATED ROAD WORK 1/2  
MILE SIGNS FROM MINOR ROUTE.  
CHANGED CONSTRUCTION SIGN  
QUANTITIES.

■ REV. 12-18-99: IN NOTES FOR ABOVE  
LAYOUT BLOCK DELETED OLD NOTE  
NO. ②.

■ REV. 7-29-03: CHANGED SIZE OF END  
ROAD WORK CONSTRUCTION SIGN FROM  
48"x24" TO 36"x18".

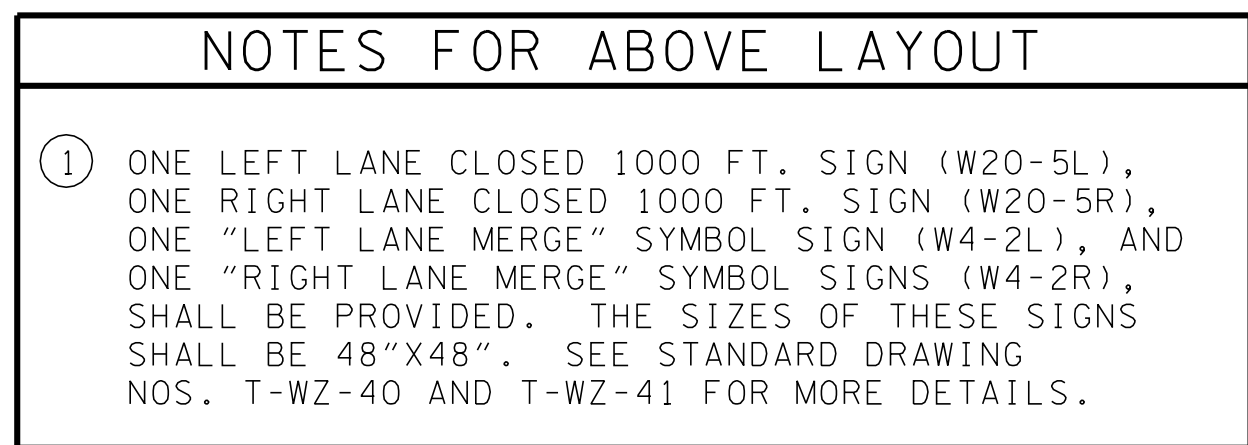

"T" INTERSECTIONS - 141.5 S.F.  
4 - LEGGED INTERSECTIONS - 178 S.F.

TRAFFIC CONTROL  
FOR SIGNALS ONLY  
PROJECTS ON 4 OR  
5 LANE MAJOR AND  
MINOR ROUTES

6-27-98	T-WZ-52
---------	---------